

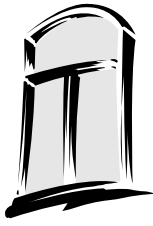

**GOLDENLINE**

**Maintenance  
Instructions**

**Screen Installation**



# Introduction

## Important Instructions

Please read before using these Maintenance Instructions

### IMPROPER MAINTENANCE

Improper maintenance may void your warranty. Please pay close attention to these instructions.

### IMPROPER BLIND INSTALLATION

Improper blind or curtain installation may void our glass warranty. Please pay close attention to the Blinds – Section 5.

### INSTALLATION INSTRUCTIONS

Should you require installation instructions, it is available on our website or refer to the contact information below.

### WARRANTY INFORMATION

Warranty information is available. Refer to the contact information below.

### CONTACT INFORMATION

EuroLine Windows Inc. 7620 MacDonald Road, Delta BC V4G 1N2

Telephone 604-940-8485 Fax 604-940-8486

Toll Free 1-800-337-8604

Web Site [www.euroline-windows.com](http://www.euroline-windows.com)

## Frame

The fixed parts of the window or door.  
The frame includes the head, jambs, sill, transoms, and mullions. The frame does not include the sash.

## Sash

The movable part of the window or door.  
The sash includes the top and bottom rails, and the left and right stiles.

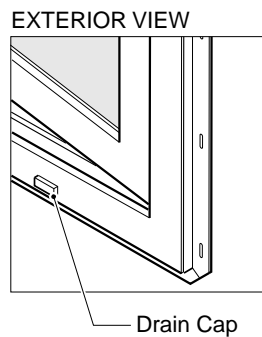

## Terminology

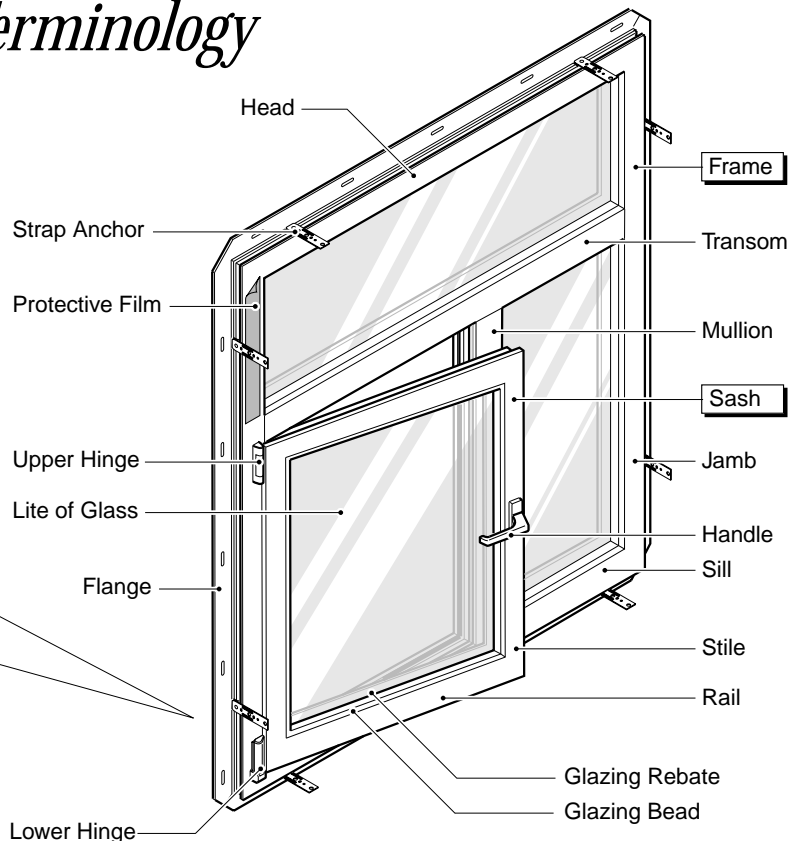

# Section 6 Screen Installation

## Note:

If the side of the screen is greater than 48" (1200mm), use 3 clips.

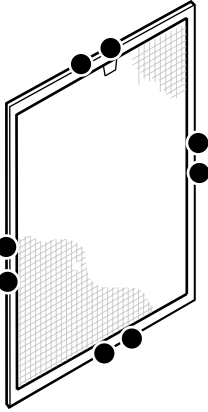

Figure 6-1. Move clips to center of frame prior to removal

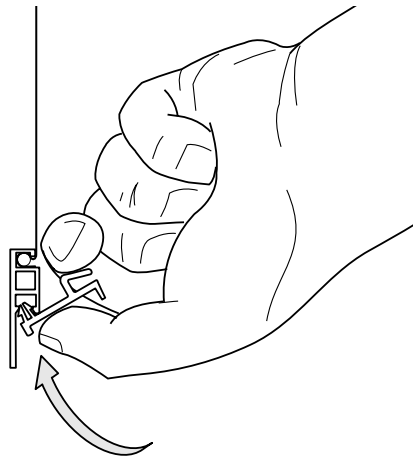

Figure 6-2. Insert clip into screen frame

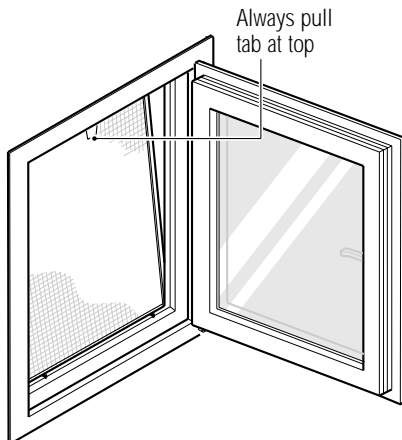

Figure 6-3. Insert bottom clips first

## GoldenLine Screen Installation

1. Install two clips on each side of the screen, except on sides of the screen greater than 48" (1200mm), use three clips. Snap the screen clips into the screen bar by gripping the clip as shown in figure 6-2. By turning the clip 30 degrees and engaging one of the barbs as shown, then pressing and rotating the clip at the same time, the barbs will snap into the grooves of the screen bar. Force may be required.
2. Place the clips in the position shown in figure 6-1 in preparation for the screen to be installed. Keep the clips at the top and sides from sliding by using a short piece of masking or duct tape to secure the clips to the interface of the screen bar.
3. With the sash open and standing inside the room, grip the screen by the sides. By holding the screen at an angle, move the unit through the window opening to outside the window.
4. Place the screen clips on the bottom screen bar onto the window frame as shown in figure 6-3, while holding the top of the screen angled out at about 15 degrees. Hold the top of the screen by the tab.
5. Now tilt in the top of the screen until the clips engage. The side clips may pop into place at the same time. If they don't, pull the clips towards the interior of the room, until they snap into place. The lip of the screen clip should be under the gasket against the frame itself. See fig. 6-4.
6. Remove the tape and slide the clips to the 1/4 points along each side of the screen, as shown in figure 6-5. If three clips are installed per side, place the third at the mid-point. Your installation is complete.

## Note:

Be careful not to drop the screen while installing. Use the nylon tab located at the top to grip the screen. Do not pull too hard on the nylon tab as it may pull out.

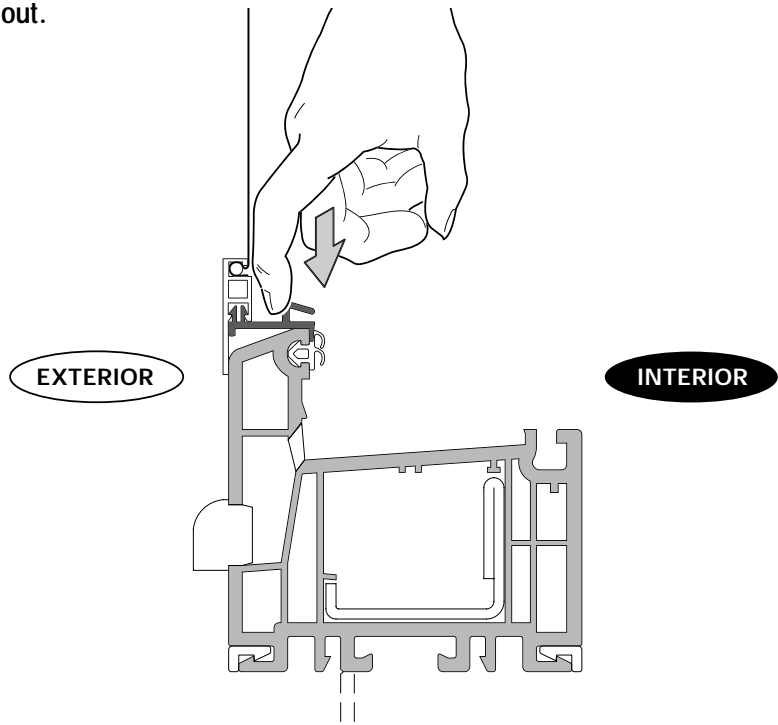

Figure 6-4. Locate clip between frame and seal, press down to locate clip

### GoldenLine Screen Removal

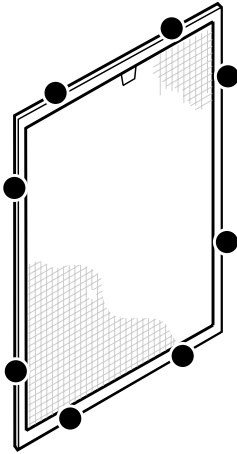

Figure 6-5. Clip locations

1. Slide the clips to the mid-point of the screen bars (figure 6-1).
2. Holding the pull-tab with your right hand, pull on the clip handles (figure 6-6) to release the clips at the head and push outward a 1/4 inch (6 mm) on the screen so as to keep the clips from re-setting themselves.
3. Pull the clip handles on the left side of the screen, while maintaining a grip on the pull-tab with your right hand.
4. With the clips released on two sides, the other will release by themselves.
5. Grip the screen with both hands and angle the screen through the opening into the room.

**Note:**

**GoldenLine screens may only be installed or removed from the interior of the building.**

**Note:**

**Do not drop the screen while removing. Use the nylon tab located at the top to grip the screen. Do not pull too hard on the nylon tab as it may pull out.**

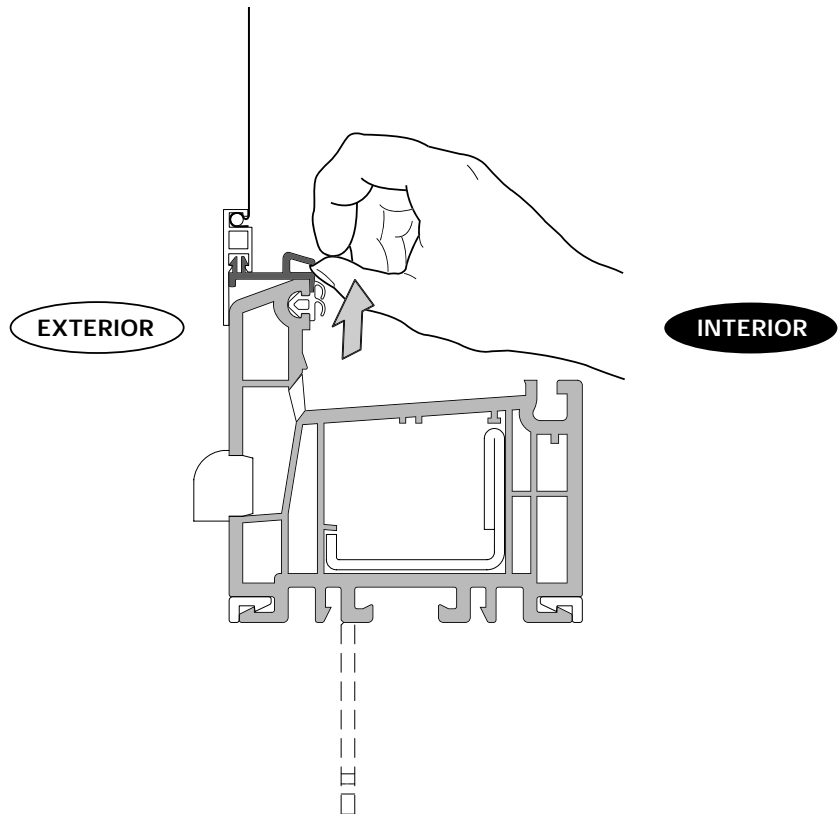

Figure 6-6. Release clip from window frame

For more information on these quality products please contact:

**EuroLine Windows Inc.**

7620 MacDonald Road  
Delta, BC. Canada V4G 1N2

T. **604.940.8485**

F. 604.940.8486

E. [mail@euroline-windows.com](mailto:mail@euroline-windows.com)

w. [www.euroline-windows.com](http://www.euroline-windows.com)

**Toll Free: 1 800 337.8604**

Other publications available from  
Euroline Windows Inc.:

Product Catalogue

GoldenLine Installation Instructions

SilverLine Installation and Maintenance Instructions

Do not reproduce this manual without prior written permission from Euroline Windows Inc.