

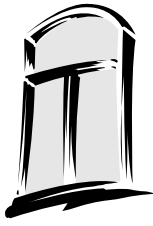

GOLDENLINE

**Maintenance
Instructions**

**Caring for your
Windows and
Doors**



Introduction

Important Instructions

Please read before using these Maintenance Instructions

IMPROPER MAINTENANCE

Improper maintenance may void your warranty. Please pay close attention to these instructions.

IMPROPER BLIND INSTALLATION

Improper blind or curtain installation may void our glass warranty. Please pay close attention to the Blinds – Section 5.

INSTALLATION INSTRUCTIONS

Should you require installation instructions, it is available on our website or refer to the contact information below.

WARRANTY INFORMATION

Warranty information is available. Refer to the contact information below.

CONTACT INFORMATION

EuroLine Windows Inc. 7620 MacDonald Road, Delta BC V4G 1N2

Telephone 604-940-8485 Fax 604-940-8486

Toll Free 1-800-337-8604

Web Site www.euroline-windows.com

Frame

The fixed parts of the window or door.
The frame includes the head, jambs, sill, transoms, and mullions. The frame does not include the sash.

Sash

The movable part of the window or door.
The sash includes the top and bottom rails, and the left and right stiles.

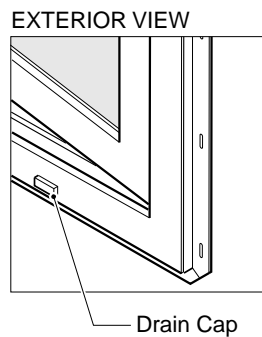

Terminology

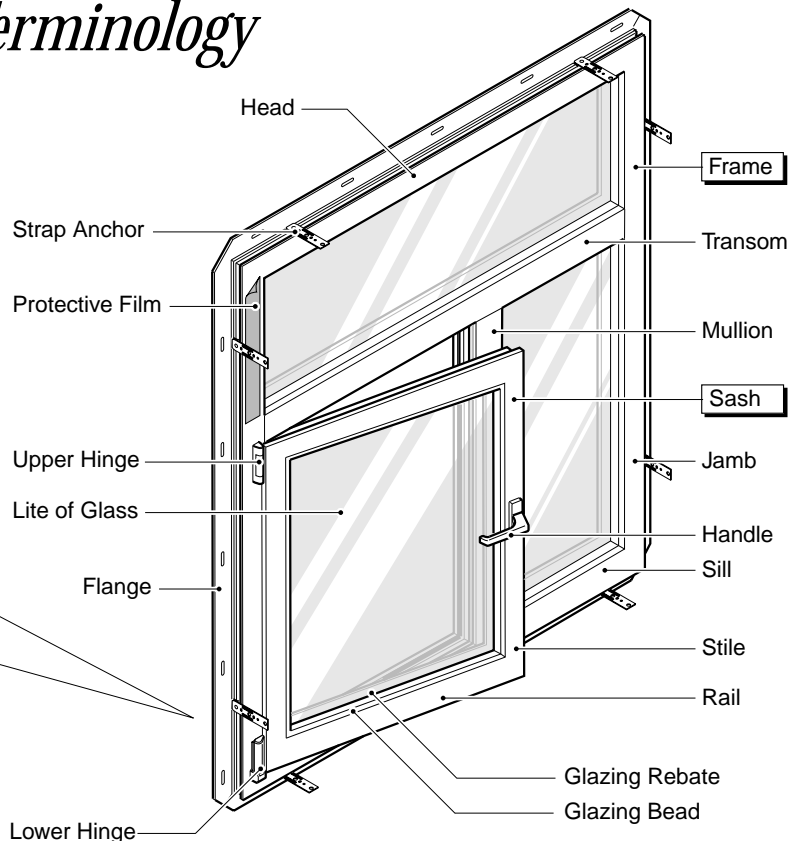

Section 2 Caring for your Windows and Doors

Congratulations! You have chosen quality windows and doors from EuroLine, manufactured with pride and care. Because these windows are made from high technology uPVC materials, they require very little maintenance. The care and maintenance tips that follow will help you care for your windows in the best way.

A Word About Protection

Always protect your EuroLine windows and doors from welding spatter, open flame, excessive heat, grinding, sparks, concrete, mortar, stucco, paint, and other harmful construction materials or processes. All of these can permanently damage both the frame finish and the glass surface. Such contaminants must be removed from the glass surface as soon as possible.

How To Clean The Glass

Use an approved window cleaning agent, following the instructions provided with the product. The cleaning agent must not be acidic or caustic since damage could result to the frame or hardware.

To remove glue, caulking or paint from the glass, contact a glass cleaning professional.

How To Clean The Frame and Sash Profiles

1. Vinyl (uPVC) Surfaces

For uPVC white or beige frames, remove light stains with a mild, non-abrasive household cleaner and a soft cloth. Apply the cleaning solution to a damp cloth, not to the frame. Wipe the soiled frame surfaces to remove dirt build up. For heavily soiled areas use light pressure on the damp cloth. Dry the interior surfaces of the frame with a damp cloth. Rinse the exterior surfaces of the frame with clean water.

For grease or oil stains, use 99% isopropyl alcohol, but only on the immediate area of the stain.

Avoid aggressive cleaning methods such as sandpaper or steel wool: these will damage the smooth surface. Do not use solvents such as acetone or paint thinner: these could affect the color of the frame.

Scratches and dents can only be removed by qualified trades people.

2. Color or Wood-Grained Film (Laminated to the uPVC)

Clean with standard cleansing agents excluding abrasive products. The film on the frame is resistant to ammonia water, aliphatic benzene and light alcoholic-water solutions.

The film is not resistant to organic solvents or mixtures of organic solvents (e.g. varnish thinners, varnish removers, polish, adhesives and the like). Do not use organic solvents of any kind, since damage will result to the film.

Scratches in the film that expose the underlying uPVC may be repaired with matching paint. Touch-up paint pencils are available from EuroLine windows.

A Word About Doors and Windows That Open

Keep the channel groove in the base of the frame free of dirt and debris. Make sure the drain holes are not blocked with dirt or debris. Blocked drain holes can affect the performance of the window.

Note:

Do not use a dry cloth to wipe the frame. This causes static electricity to build up, which attracts dust and dirt to the frame.

Cleaning of Hardware

Clean hardware with clean water to remove grit and grime. Do not use acidic or caustic cleaning substances.

Lubrication of Hardware

Lubricate your hardware once a year or as conditions dictate, with a light, petroleum-based oil to maintain its factory-smooth operation. In coastal areas, rinse and relubricate every three months, or more frequently as conditions dictate

Tilt & Turn Windows and Doors

Lubricate the upper bar hinge and all of the locking cams.

Hinged Doors

Lubricate all of the locking cams

Tilt & Glide Doors

Lubricate all of the locking cams

Push-Out Casement and Awning Windows

Lubricate all of the pivot points on the hinges (top and bottom).

How to Lubricate the Upper Bar Hinge (Tilting Sashes Only)

1. Open the sash to the Tilt position.
2. Apply oil to the moving parts of the bar hinge assembly.
3. Close the sash. Rotate the handle between the Lock, Tilt and Turn positions several times.

Note:

In coastal (salt-water) locations, rinse the hardware every three months (or as conditions dictate) with fresh water, and relubricate.

In beach areas, rinse sand and grit from hardware as required.

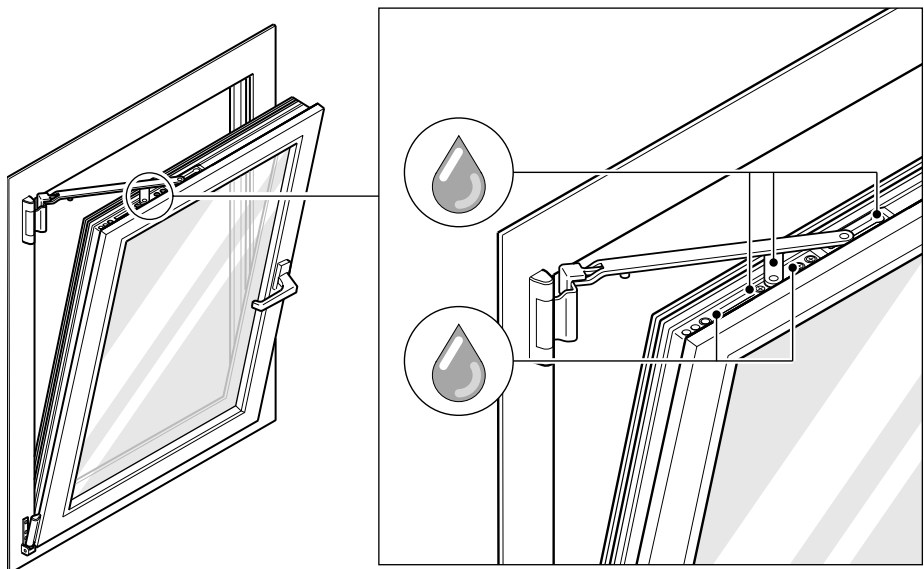

Figure 2-1.



How to Lubricate the Locking Cams (All Sashes)

All GoldenLine sashes with multipoint locks have several locking cams around the perimeter of each sash. Locking cams may be located on the top, sides, or bottom of a sash.

1. Open the sash to the appropriate position (Tilt, Turn or Glide) and find the location of each locking cam
2. Apply oil to the slots on both sides of the of the locking cam heads.
3. Close the sash. Rotate the handle between the Lock and Open positions several times

Tilt & Turn Hardware Parts Description

Part	Mounted on
1. Top corner (VSO)	sash
2. Shear	sash
3. Shear hinge	sash
4. Cover cap for #3	sash
5. Top frame hinge	frame
6. Cover cap for #5	frame
7. Top hinge pin	frame
8. Back lock	sash
9. Bottom frame hinge	frame
10. Cap for #9	frame
11. Cap for #9	frame
12. Sash hinge	sash
13. Cap for #12	sash
14. Bottom extension	sash
15. Tilt plate	frame
16. Bottom corner	sash
17. Mushroom cam	sash
18. Tilt and Turn handle	sash
19. Strike plate	frame
20. Eccentric locking cam	sash

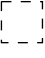
-  = Lubricate here
-  = Eccentric locking cam
-  = Mushroom locking cam
-  = Important areas for safety. Visually inspect hinges for tightness of fasteners or damage to hinges after installation and every six months.

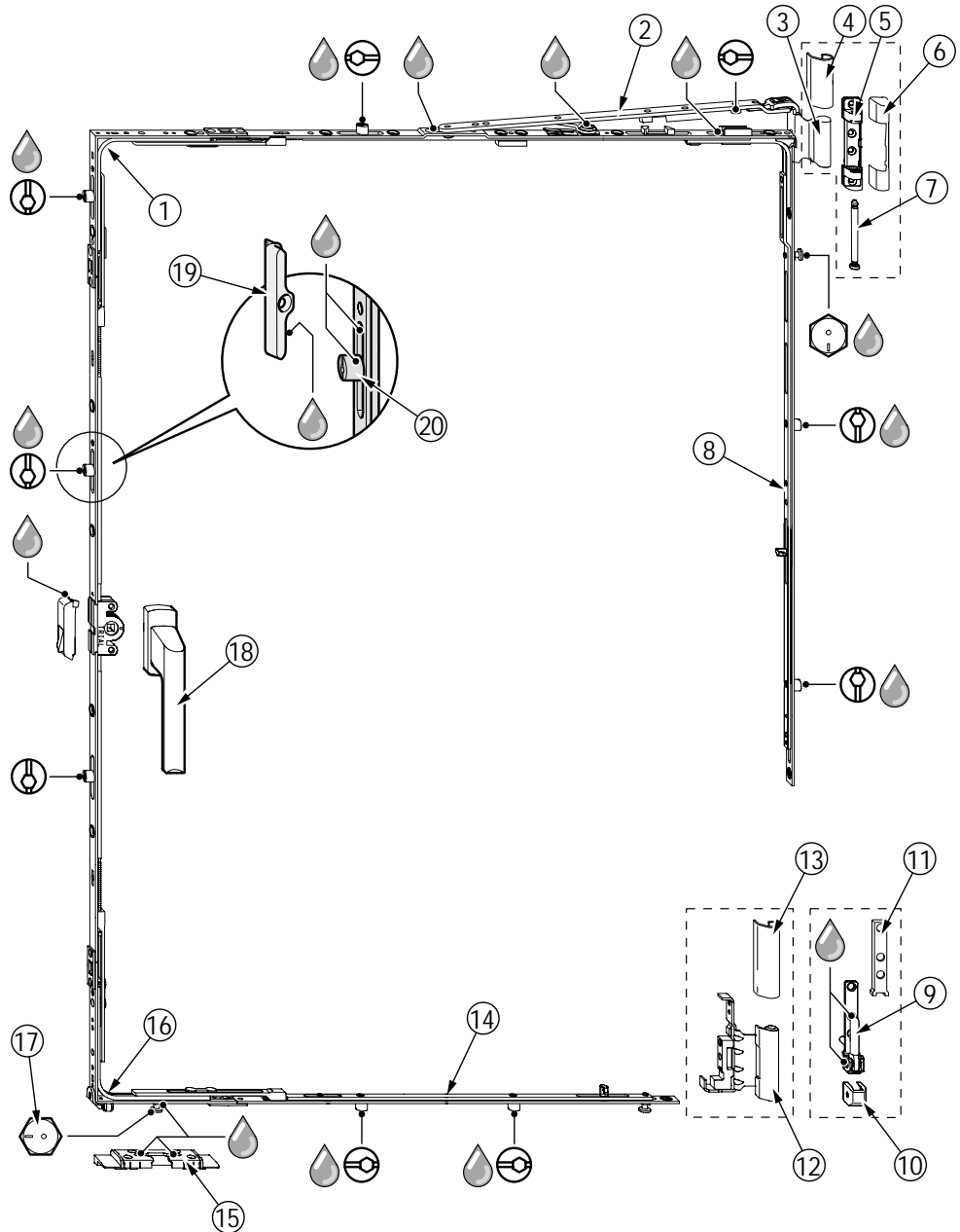

Gaskets

All gaskets must be examined periodically for damage. Windows or doors with damaged gaskets will not perform properly. If you have air or water leaks, inspect the gaskets carefully. Replace the gasket if required.

Figure 2-2.

For more information on these quality products please contact:

EuroLine Windows Inc.

7620 MacDonald Road
Delta, BC. Canada V4G 1N2

T. **604.940.8485**

F. 604.940.8486

E. mail@euroline-windows.com

w. www.euroline-windows.com

Toll Free: 1 800 337.8604

Other publications available from
Euroline Windows Inc.:

Product Catalogue

GoldenLine Installation Instructions

SilverLine Installation and Maintenance Instructions

Do not reproduce this manual without prior written permission from Euroline Windows Inc.