



EuroLine
Windows INC.

Installation Instructions

GOLDENLINE

*Casement &
Awning Windows*

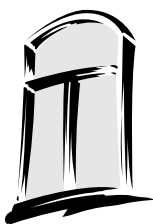

Introduction

Important Instructions

Please read before you start installation

WARNING

Leaving tightly spaced windows/doors in the sun can result in overheating of the sealed units and extrusions, which may result in damage. Ensure that product is secured to wall to prevent any damage.

WARNING

Improper installation may void all warranties expressed or implied. Installation Instructions are also available on our web site.

RECEIVING:

Carefully inspect all windows and doors at the time you receive them and again at the time you install them. Any visible defects with the product must be reported to Euroline before installation begins.

HANDLING:

Window and door units are to be handled carefully to avoid damage. They must be moved in the vertical position. If the product is supplied with a flange it must rest on shipping blocks that are temporarily attached. **COLD WEATHER CAUTION: Use special care when handling or installing below 5° C (40°F). Avoid any impact to frames, sash or glazing bead.**

STORAGE:

Store the units at a slight lean against a wall on a flat, level area, under cover. Allow adequate spacing between the products for ventilation.

BUILDING CODES:

It is the responsibility of the owner, architect or builder to select and install products in compliance with applicable laws, regulations and building codes.

BUILDING ENVELOPE:

The design of the building envelope is the responsibility of the owner, architect, builder or building envelope consultant. The attachment of the window/door assembly to the building envelope, to assure continuity of the water/air/vapor barriers, is the contractual obligation of others. *This is not the responsibility of EuroLine.*

INSTALLATION:

Proper installation is necessary for this window or door to perform as designed and rated for water and air resistance. If you have Euroline shop drawings, supplemental information is provided. **Euroline products must be installed plumb, level and square.**

CARE AND MAINTENANCE:

Protect windows/doors from welding splatter, grinding sparks, concrete, mortar, stucco, paint and other harmful construction materials. To clean vinyl, use a mild soap and water solution. To clean the glass, use a soft, grit free cloth and glass cleaner. On all operable windows and doors, keep channel at sill free of debris and protect sills from traffic damage. Keep all weep holes open for proper drainage. The protective film must be removed on completion of installation. Clean and lubricate all hardware after construction. Ongoing maintenance and adjustments are described in our maintenance manual, available by contacting our sales office or visiting our website.

PERFORMANCE DATA:

Our products are tested to ASTM test standards, CSA A440 Standards, and are NFRC certified for thermal performance. Data is available upon request.

CONTACT INFORMATION

EuroLine Windows Inc. 7620 MacDonald Road, Delta BC V4G 1N2

Telephone 604-940-8485 Fax 604-940-8486

Toll Free 1-800-337-8604

Web Site www.euroline-windows.com

Materials and Tools Required

Sealant Joint Placement

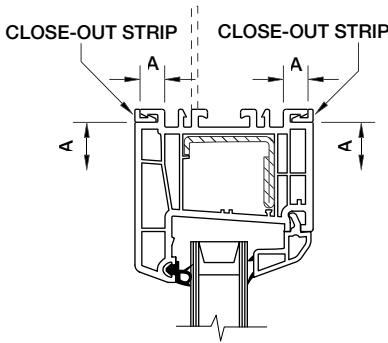

CAUTION

The close-out strip is not designed for air and water tightness.

To ensure an air and water seal, joint placement is as shown in one or more of the locations shown "A".

Sealant joint must be 7/8" (22mm) below drain caps on the sill.

Check with your sealant supplier that materials are compatible with the extrusion.

Tools

- Spirit level
- Framing hammer
- Screwdriver/screw gun
- Tape measure
- 11 mm wrench
- 4 mm allen key

Materials

- Shims: use Euroline approved 4" (100 mm) x 1 1/2" (30 mm), thicknesses from 1/8" to 1/2" (available from Euroline). **DO NOT USE WOOD SHIMS.**
- 2" Galvanized Roofing Nails (10 1/2 ga.)
- 1 1/2" #10 Pan Head Tapping Screws (cadplated)

Rough Openings

Make sure that the rough openings are square, and that they have a level sill and plumb (vertical) jambs. Make sure that the outside face of the wall is straight and plumb. If a rough opening is out-of-square, adjust the thickness of the shim blocks as necessary to make sure that you install the window or door frame in a square, level and plumb way.

If you see any rough openings that are not acceptable for frame installation, tell the general contractor or the party responsible for the construction. Get written authorization from the general contractor or from the responsible party before you install frames in unacceptable openings.

Make sure that the general contractor corrects the rough opening if you find the rough opening does not allow you to install the frame perfectly level, square, straight in every direction and plumb, and does not provide a minimum of 3/8" (10 mm) and no larger than 1/2" (12 mm) clearance between the top of the frame and the top of the rough opening.

Frame

The fixed parts of the window or door. The frame includes the head, jambs, sill, transoms, and mullions. The frame does not include the sash.

Sash

The movable part of the window or door. The sash includes the top and bottom rails, and the left and right stiles.

EXTERIOR VIEW

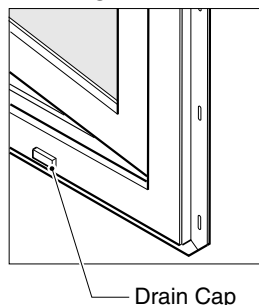

Terminology

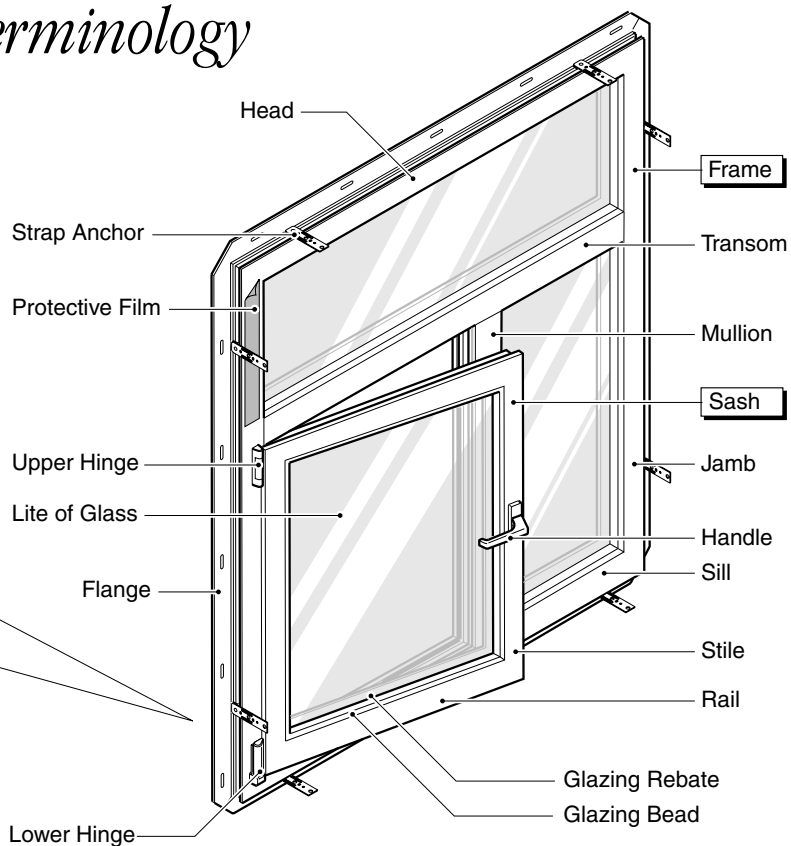

Section 3

Casement & Awning (Push-Out) Windows

WARNING

Head flashing must be less than 1" below the frame or sash interference will result.

Rough Opening Clearances

To allow for small defects in the size, level, or squareness of the rough opening, EuroLine recommends that you provide these clearances between the window frame (excluding flanges and accessory sills) and the rough opening.

Head (top of opening)	3/8" (10 mm) min	1/2" (12 mm) max
Jambs (sides of opening)	3/8" (10 mm) min	1/2" (12 mm) max
Sill (bottom of opening)	3/8" (10 mm) min	1/2" (12 mm) max

How To Install Casement Windows

1. Prepare The Frame

- 1.1 Remove the wooden shipping blocks that are attached to the flange (if supplied).
- 1.2 If strap anchors are included with the window, rotate them until they are at right angles to the frame. Bend the strap anchors inwards about 45°. See fig. 3-1.

Note: Some windows do not have strap anchors.

If shop drawings are required for the project, refer to these drawings for supplemental installation instructions.

2. Put The Frame In The Rough Opening

- 2.1 Having prepared the rough opening as per building codes and/or Architect/Building Envelope Specialist, ensure the window is installed in a weather tight manner.
- 2.2 If supplied, swing out strap anchors attached to the frame. Strap anchors should point to the interior of the building. **Do not nail or screw strap anchors until step 2.8.**
- 2.3 Center window into opening, ensure window is right side up.
- 2.4 Shim sill of window 2" from the corners and on both sides of any mullions with 4" x 1 1/2" shims (See fig. 3-2). **Adjust the height of the shims to obtain a level sill**, ensuring you have 3/8" gap at the head (inter-storey deflection not to exceed $\pm 3/8"$).

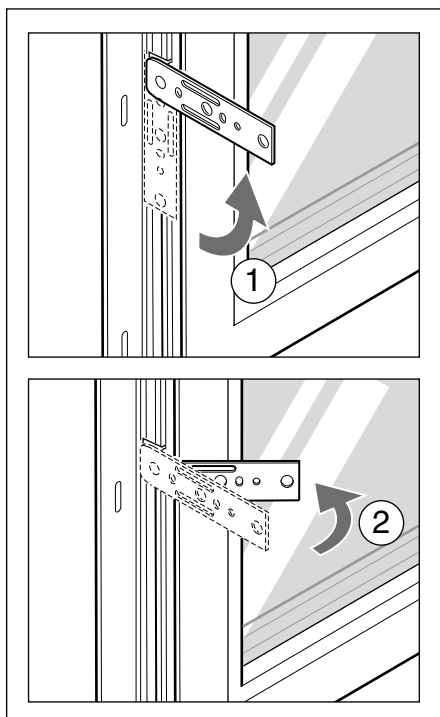

Figure 3-1. How to rotate and bend the strap anchors

CAUTION

DO NOT put shims under the strap anchors!

Window Width W	Shim Spacing	
	a	b
<36"	2 1/2"	7 1/2"
36" – 70"	2 1/2"	10"
>70"	2 1/2"*	10"*

* Plus add shim at centerline of window

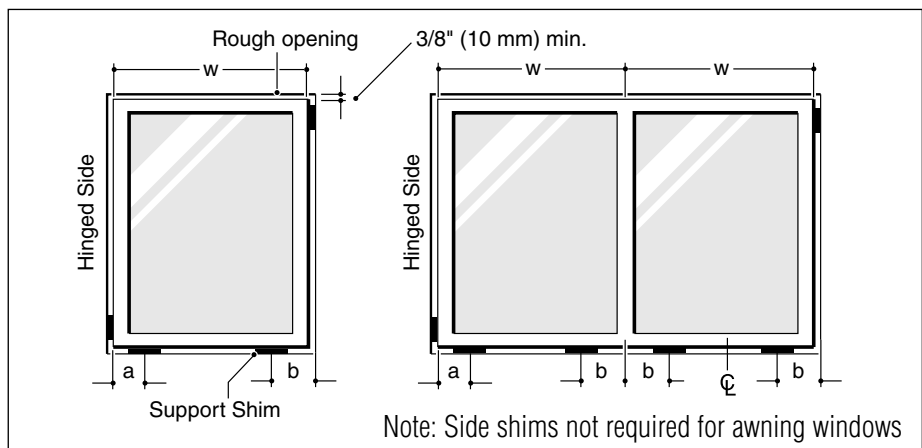

Figure 3-2. Where to put the support shims

WARNING!

DO NOT nail the top flange to the wall!

- 2.5 Fasten bottom corners of flange to the wall with 2" galvanized nails or 1 1/2" #10 tapping screws.
- 2.6 **Plumb the frame jambs with a level** and fasten the two top corners of the flange to the wall.
- 2.7 Use a straight edge to ensure the frame is straight on all four sides. Fasten the flange every second slot. **DO NOT nail or screw too tight.**
- 2.8 Nail or screw all strap anchors to the wall.
- 2.9 Remove protective film from all profiles immediately after installation. See fig. 3-6.
- 2.10 Install drain caps.

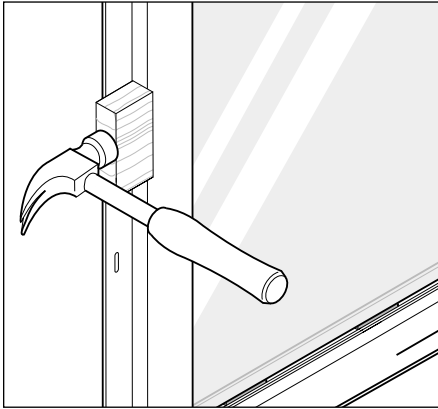

Figure 3-3. How to straighten a bowed frame

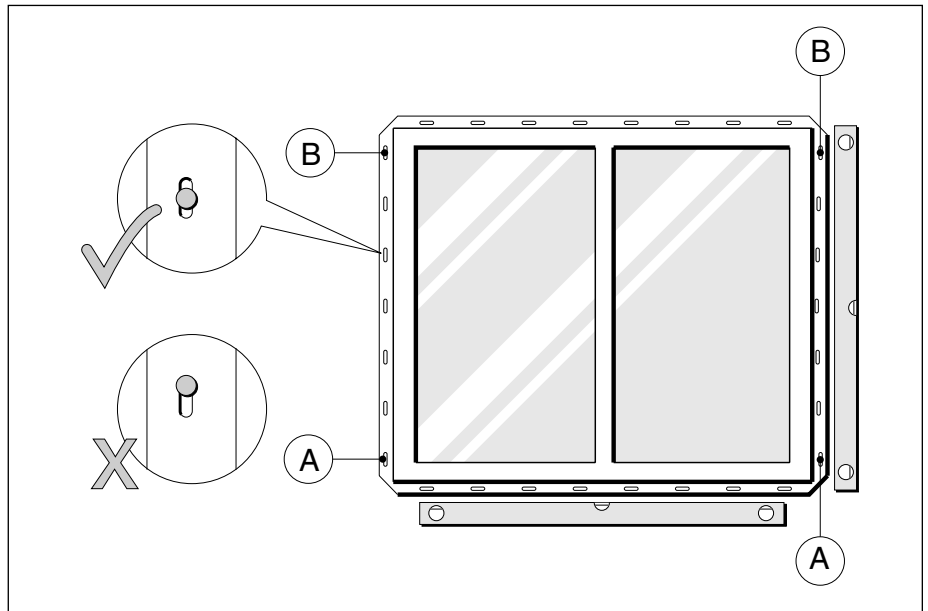

Figure 3-4. Where to fasten the flanges — exterior view

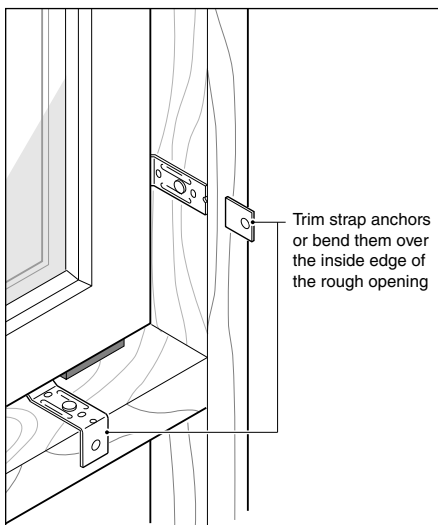

Figure 3-5. How to attach the strap anchors

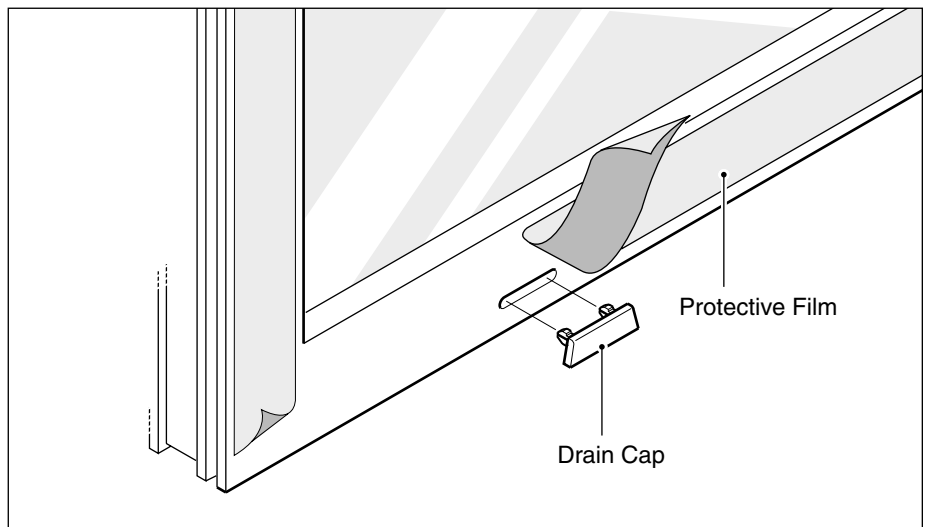

Figure 3-6. How to remove the protective film and install the drain caps — exterior view